

Greddy



Instruction Manual P/N: 12559004

Make: **Honda** Model: **Accord** Year: **2013-2014** Engine: **V6-3.5L**



- Please read the entire instruction manual before proceeding.
- Ensure all components listed are present.
- If you are missing any of the components, call customer support at 951-493-7100.
- Ensure you have all necessary tools before proceeding.
- Do not attempt to work on your vehicle when the engine is hot.
- Disconnect the negative battery terminal before proceeding.
- Retain factory parts for future use.

Label	Qty.	Description	Part Number
A	1	Air Filter (Pro DRY S)	61-90131 (Grey Media)
B	1	Tube (Polished)	05-T1021P1
C	1	Tube (Wrinkle-Black)	05-T1021B1
D	1	Housing	05-T1021B2
E	1	Coupling Silicone	05-01196
F	1	Trim 1/16" (7 Inches)	05-00149
G	1	Trim 1/16" (9.5 Inches)	05-00149
H	1	Hose 5/8" (15 Inches)	05-00069
I	1	Hose 5/16" (20 Inches)	05-00112
J	1	Isolation Mount M6	03-50022
K	2	Clamp, 044	03-50019
L	1	Spacer	03-50120
M	1	Screw, Hex Head M6	03-50032
N	2	Nut, Hex	03-50059
O	3	Washer, Flat	03-50070

Installation will require the following tools:

Phillips screw driver, 8mm nut driver, ratchet, extension, 10mm socket & pliers

Note: Legal in California for use on race vehicles only. The use of this device on vehicles used on public streets or highways is strictly prohibited in California and others states that have adopted California emission regulations.

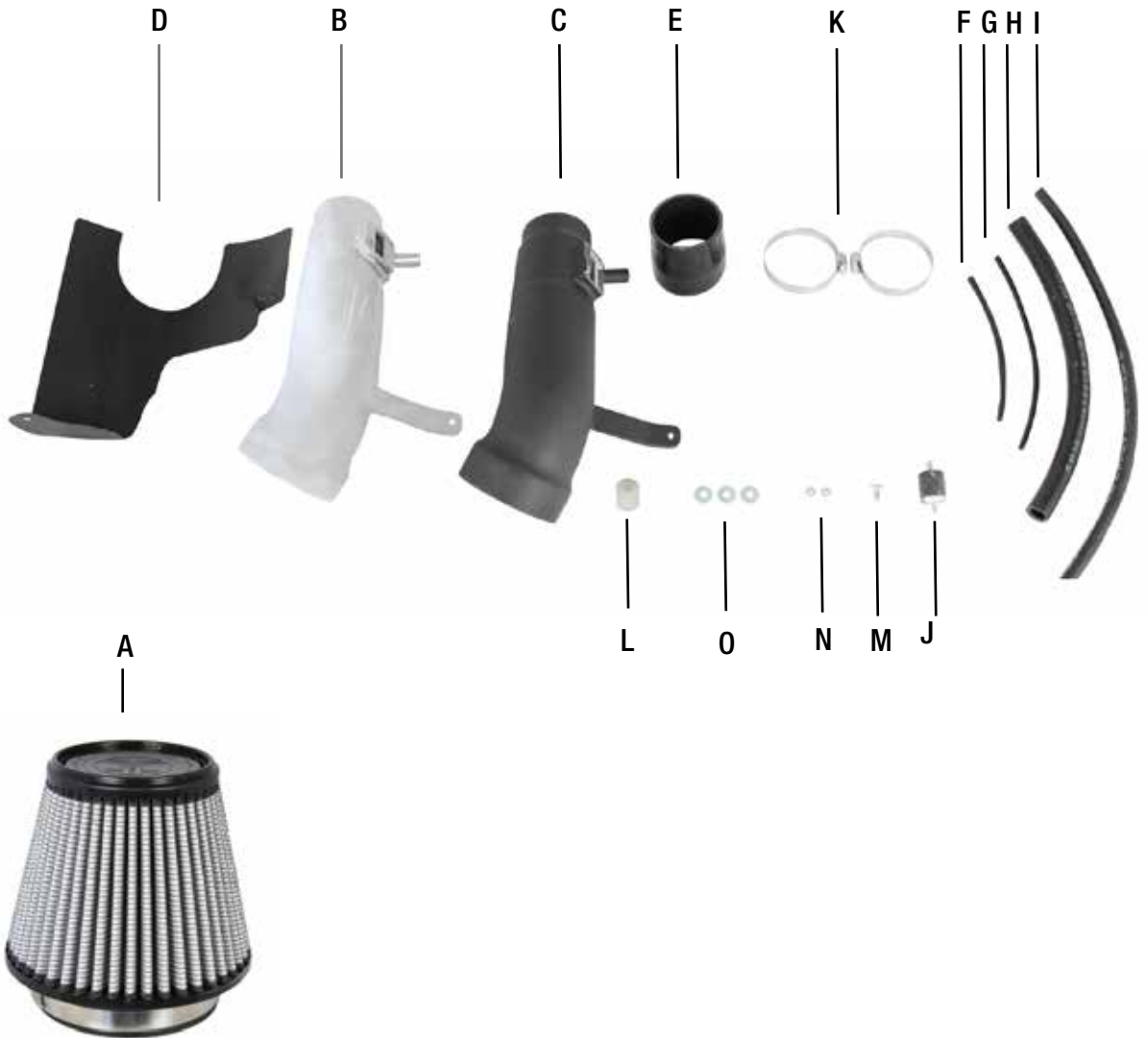



Figure A

Refer to Figure A for steps 1-6

Note: Make sure car is cool before starting this installation to avoid coolant burns.

Step 1: Pop off engine cover from grommets and remove engine cover (1) .

Step 2: Disconnect the MAF sensor, and then remove the wire harness from the OE air box (2) .

Step 3: Disconnect the crank case line from the OE tube (3) .

Step 4: Loosen the clamp connecting the OE tube to the throttle body (4) .

Step 5: Remove the two bolts holding the OE air box (5) .

Step 6: Pull out the OE air intake system out of the engine bay (6) .



Figure B

Refer to Figure B for step 7

Step 7: Disconnect the coolant hose connecting to your throttle body (7) and replace with the provided hose. (Have a shop towel or rag handy to catch any leaking coolant) Re-use your stock clamps. Disconnect the crank case line and remove the coolant hose/vacuum line assembly (This hose/metal tube will not be reused) (8).

NOTE: Make sure car is cooled down before disconnecting the coolant hose. The coolant could be extremely hot and cause serious burns.

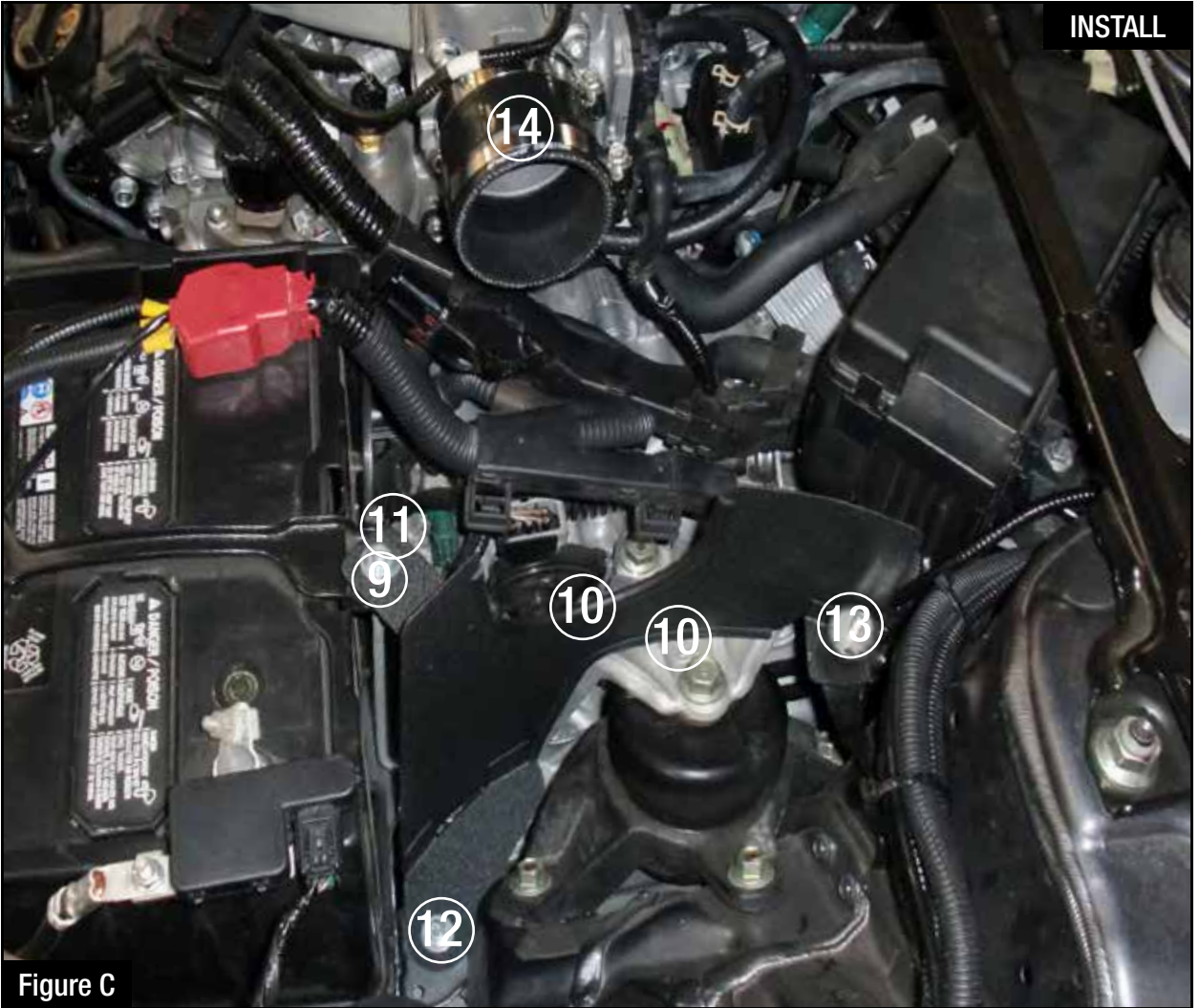

Figure C

Refer to Figure C for steps 9-12

Step 8: Install the supplied nylon spacer onto the battery hold down (9).

Step 9: Install provided trim onto the edge of the GReddy housing. Place the GReddy housing into the vehicle as shown above (10).

Step 10: Secure housing to the battery hold down using washer and nut provide (11) and to the bottom factory mounting location using bolt and washer provided (12).

Step 11: Use the isolation mount to secure to the housing to the third factory mounting location (13).

Step 12: Install the silicone coupling with clamps onto the throttle body (14). Do not tighten clams yet.

**Figure D****Refer to Figure D for steps 13-14**

Step 13: Remove the MAF sensor from the OE intake tube and install into the GReddy tube (15).
(Re-use the factory MAF screws and o-ring)

Step 14: Install the GReddy filter onto the intake tube and tighten (16).



Figure E

Refer to Figure E for steps 15-22

Step 15: Install the GReddy intake tube onto the coupling and isolation mount (17).

Step 16: Re-connect the MAF sensor (18).

Step 17: Place the provided crank case hose onto the GReddy intake tube and valve cover (19).

Step 18: Install the provided nut and washer onto the isolation mount to secure tube (20).

Step 19: Tighten all clamps and nuts.

Step 20: Re-install engine cover (21).

Step 21: Place the GReddy decal onto the GReddy intake tube as shown.

Step 22: Your installation is now complete. Thank you for choosing GReddy!

Page left blank intentionally

Pro DRY S Air Filter



P/N: 61-90131

To purchase any of the items above, view airflow charts, dyno graphs, photos, and video; please go to GReddy.com.

GReddy

GReddy Performance Products
9 Vanderbilt, Irvine CA 92618
TEL: 949.588.8300 • E-Mail: Tech@GReddy.com